

# MIURA PRO & ASCEND PLATFORM

SMART HARDWARE MEETS INTELLIGENT ESTATE MANAGEMENT

In a rapidly evolving retail and service economy, businesses need more than just payment terminals—they need smart, connected platforms that can be remotely managed, updated, and scaled.

Miura Pro, our Android-based payment terminal, is engineered for versatility and power. **When paired with Ascend, Miura's cloud-based Terminal Management System (TMS), it becomes a true enterprise-ready solution**—bringing visibility, security, and control to every device in your payment estate.

## MEET THE MIURA PRO

**Miura Pro is a full-featured Android payment terminal that supports:**

- Contactless, Chip & PIN, and Magstripe payments.
- 5.5" touchscreen display.
- Built-in barcode scanner and printer.
- Cellular, Wi-Fi and Bluetooth connectivity.
- PCI PTS 6.0 certification.

Miura PRO is designed for high-traffic environments like retail, hospitality, and delivery services where reliability and flexibility are essential.



### Processor & OS:

Android 11, 2GHz Quad Core + Security Processor



### Certifications:

CB, CE, PSE, TELEC/JATE, UKCA, FCC, ISSED, DoE/CEC, NrCan



### Battery:

120 hours of use, processing up to 1,200 transactions



### Display:

5.5 Inch Colour , Multi-Touch , Resolution 1280 \* 720



### Communications:

4G, 3G, Bluetooth 5.0 + BLE, Wi-Fi - 2.4GHz, 5GHz 802.11 a/b/g/n/ac



### Camera:

Rear Facing 5 MP Auto Focus, QR Code & Bar Code reading



### Payment Methods: Contact /

Contactless EMV for global & local payment schemes

## WHY TERMINAL MANAGEMENT MATTERS

Deploying smart hardware is just the start. Without visibility into terminal performance, configuration, or security, businesses risk:



Operational downtime



Outdated software or compliance lapses



Inconsistent customer experience



Poor scalability across locations

Enter **Ascend**, Miura's platform-first TMS built for organisations that want control, automation, and insight.

## MIURA PRO & ASCEND: UNIFIED SCALABLE, SECURE

When Miura Pro is activated on Ascend, you unlock:



### SEAMLESS DEPLOYMENT & DEVICE MANAGEMENT

- Activate, suspend, or reassign devices instantly.
- View live metrics: battery, signal, OS version, app installs.
- Update firmware and apps remotely with zero disruption.



### ADVANCED SECURITY & COMPLIANCE

- EMV configuration management.
- Remote Key Injection (RKI) per device.



### ESTATE INTELLIGENCE AT SCALE

- Dashboards for transaction health, terminal status, & user activity.
- Filterable transaction reports by device, merchant & transaction type.
- Retrieve and resend digital receipts.



### CUSTOM PROFILES, TAILORED EXPERIENCES

- Push mandatory or optional app bundles.
- Define default configurations by organisation, merchant, or terminal.
- Use App Connect or custom tools for on-device installation.

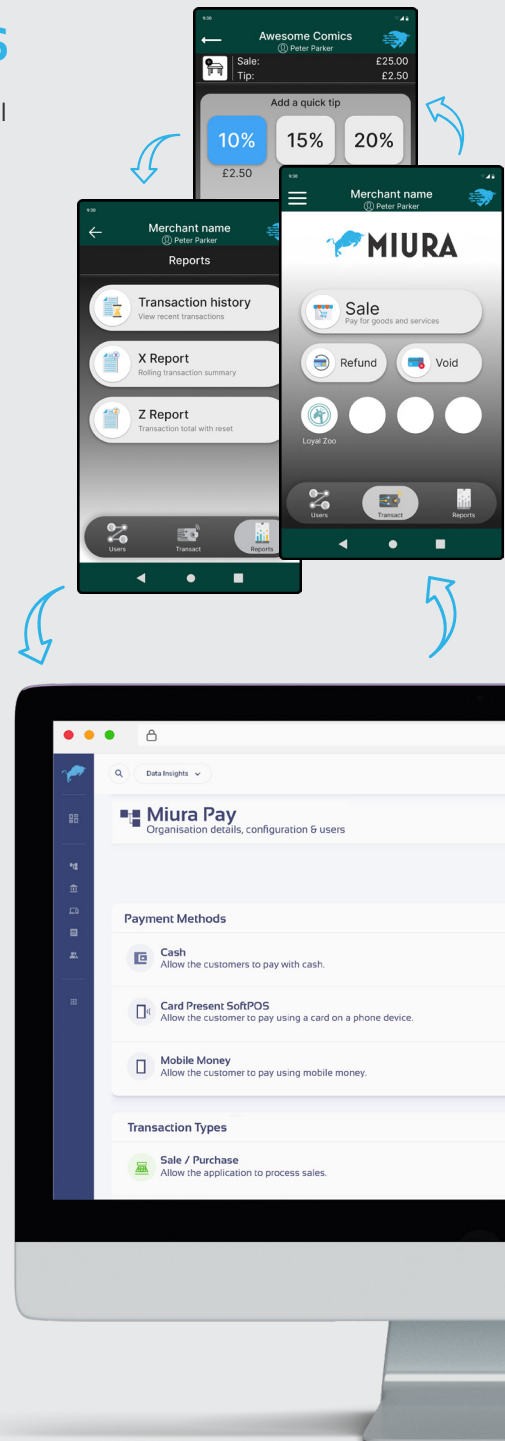

## WHO BENEFITS



**Retail chains** streamlining terminal rollouts across stores.



**ISVs & PSPs** managing large client estates.



**Field teams** needing quick insights or device resets.



**Operations lead** wanting fewer service calls and lower TCO (Total Cost of Ownership).

## BUSINESS IMPACT

Outcome	MIURA PRO + Ascend Benefits
Faster onboarding	Provision terminals remotely in minutes
Fewer support tickets	Real-time diagnostics and updates
Stronger compliance	End-to-end encryption, EMV + RKL control
Scalable growth	Flexible hierarchy for orgs, merchants, devices

## READY TO SCALE SMARTER?

Miura Pro with Ascend is the future of terminal estates: **mobile-first, cloud-managed, and partner-focused.** Whether you're onboarding 10 or 10,000 devices, Ascend ensures every Miura Pro is fully configured, fully secure, and always ready to serve.

### LEARN MORE:

**Email:** [Info@miurapay.com](mailto:Info@miurapay.com)

**MIURA PRO:** [www.miurapay.com/miura-pro](http://www.miurapay.com/miura-pro)

